

**DILLON**

**Bench Top Testing  
Accessories Catalog**

---

**This page left intentionally blank.**

---

# Dillon

## Bench Top Testing Accessories Catalog

### Table of Contents

#### Hooks1

Swivel hooks .....	5
Peg hooks .....	5
Test hooks .....	5
Flip cap accessory .....	5

#### Grips ..... 6-8

Clevis grip .....	6
Lever operated cam grip .....	6
Spring loaded roller grip .....	6
Film grip .....	6
Wedge grip .....	6
Parallel grips .....	7
Small parallel grips .....	7
Fabric grips .....	7
Pin vice .....	7
Pin chuck .....	7
Wire grips .....	8
Miniture filament fixtures .....	8
Multi jaw gripping fixture .....	8

#### Compression plates ..... 9

Hardened & ground .....	9
Nickel plated .....	9
Oil black finish .....	9
Vented .....	9
Self levelling .....	9

#### Terminal testing ..... 10-11

Adjustable test hook .....	10
Cable cam grip .....	10
Double cam grip .....	10
Rotational crimp receptacle .....	10
Spade terminal testing .....	10
Flag terminal accessory .....	11
Wedge grips .....	11

---

**Pages are numbered consecutively beginning with the cover page.**

<b>Spring testing</b> .....	<b>12</b>
Adjustable spring receptacle .....	12
Torsion spring accessory .....	12
<b>Peeling testing</b> .....	<b>13</b>
Peel wheeling accessory .....	13
<b>Manual handling</b> .....	<b>14</b>
Trolley pushing adaptor .....	14
Padded adaptor set .....	14
Manual handling chain .....	14
Force gauge cradle .....	14
<b>Adaptors &amp; brackets</b> .....	<b>15</b>
Dovetail bracket .....	15
Extended dovetail bracket .....	15
MWD/M5KNE swivel bracket for AFTI .....	15
Adaptors .....	15
Tension block module .....	15
<b>General force accessories</b> .....	<b>16-18</b>
Toy testing - teddy bear fixture .....	16
Simulated child jaws (pair) .....	16
Radiused food probe .....	16
Inverted chisel .....	16
Cone point .....	16
Chisel point .....	17
Extension rods .....	17
Overload protection device .....	17
Rod end bearings .....	17
Load buttons .....	17
Force gauge cradle .....	18
Pistol grip .....	18
MWD/M5KNE crosshead AFG mount .....	18
MDD feet (pair) .....	18
<b>Torque fixtures</b> .....	<b>19-20</b>
Bottle / cap torque fixture .....	19
Mount - static torque transducer .....	19
Mount - torque sense head .....	19
Rundown fixture .....	19
3-jaw chuck .....	19
Square drive adaptors .....	20
<b>AFG/AFTI cables</b> .....	<b>21</b>
<b>Accessory kit</b> .....	<b>22</b>

# Hooks

## SWIVEL HOOKS

Swivel hooks specifically designed to facilitate easier operator setup when testing tension springs. Usually used in conjunction with fixed test hooks.

ØA	Radius B	RATED UP TO	FIXING THREAD	PART NO.
5mm (0.02in)	9mm (0.35in)	500N	10/32 UNF	49755-0012
6mm (0.24in)	7mm (0.28in)	1000N	10/32 UNF	49755-0020

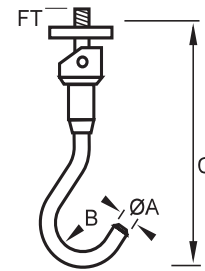

## PEG HOOKS

Designed for mounting small and miniature tension springs.

ØA	B	C	RATED UP TO	FIXING THREAD	PART NO.
1.5mm (0.06in)	30mm (1.18in)	6.6mm (0.25in)	50N	10/32 UNF	49755-0038

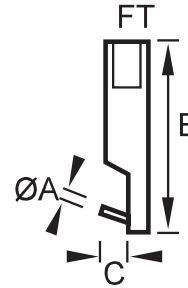

## TEST HOOKS

ØA	Radius B	RATED UP TO	FIXING THREAD	PART NO.
3.2mm (0.13in)	4mm (0.16in)	50N	10/32 UNF	49755-0046
6mm (0.24in)	7mm (0.28in)	1000N	10/32 UNF	49755-0053
6mm (0.24in)	7mm (0.28in)	2500N	5/16 UNC	49755-0061

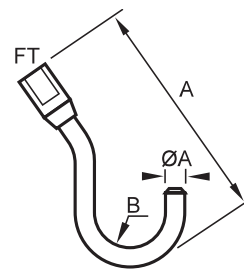

## FLIP CAP ACCESSORY

Designed to test the opening force of flip caps.

A	B	RATED UP TO	FIXING THREAD	PART NO.
25mm (0.98in)	20mm (0.79in)	100N	10/32 UNF	49755-0079

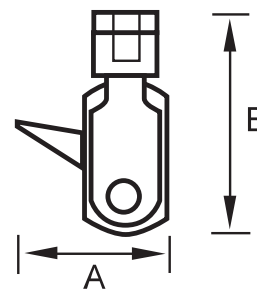

# Grips

## CLEVIS GRIPS

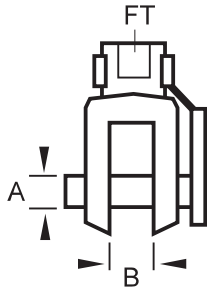

Designed for testing heavy-duty tension springs.

A	B	RATED UPTO	FIXING THREAD	PART NO.
5mm (0.2in)	5mm (0.2in)	1000N	10/32 UNF	49755-0095
8mm (0.31in)	8mm (0.31in)	1000N	5/16 UNC	49755-0103

## LEVER OPERATED CAM GRIPS

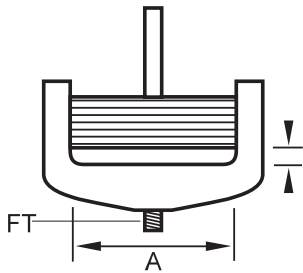

Self tightening lever operated cam grips give positive locking on various materials for tensile testing.

MAX SAMPLE SIZE (A x B)	TYPE	RATED UPTO	FIXING THREAD	PART NO.
30mm (1.18in) wide x 5mm (0.2in) thick	Smooth	500N	10/32 UNF	49755-0111
70mm (2.76in) wide x 5mm (0.2in) thick	Smooth	500N	10/32 UNF	49755-0129
30mm (1.18in) wide x 5mm (0.2in) thick	Serrated	500N	10/32 UNF	49755-0137
70mm (2.76in) wide x 5mm (0.2in) thick	Serrated	500N	10/32 UNF	49755-0145

## SPRING LOADED ROLLER GRIP

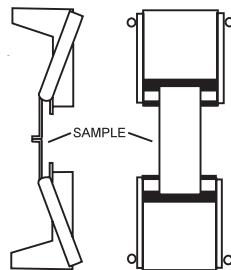

Designed to suit materials prone to slipping e.g. woven textile, film, foam, etc. By winding the sample around the surface of the roller, the load is spread, thereby increasing the gripping area.

SAMPLE SIZE DIAMETER	RATED UPTO	FIXING THREAD	PART NO.
50mm wide	500N	10/32 UNF	49755-0152
100mm wide	500N	10/32 UNF	49755-0962

## FILM GRIPS

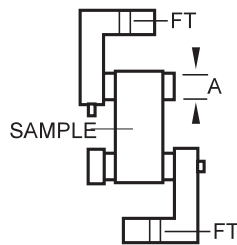

Used for flexible samples where conventional grips create stress points reducing tensile strength. Here the sample is wrapped around the drum spreading the load around the diameter.

SAMPLE WIDTH	A	RATED UPTO	FIXING THREAD	PART NO.
50mm (2in)	20mm (0.79in)	500N	10/32 UNF	49755-0160

## WEDGE GRIPS

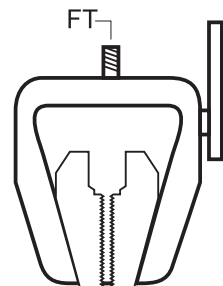
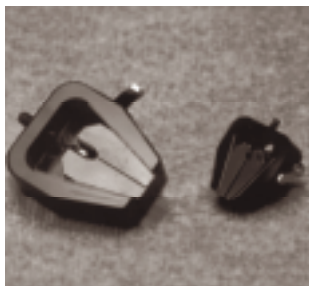

These self tightening tensile grips feature lever operated quick release serrated jaws, so providing excellent sample grip, on a variety of material.

MAX SAMPLE SIZE/JAW DEPTH	RATED UPTO	FIXING THREAD	PART NO.	
15 X 5mm (0.59 X 0.12in)	17mm (0.67in)	1000N	10/32 UNF	49755-0178
25 x 10mm (0.98 X 0.39in)	28mm (1.10in)	10000N	5/16 UNC	49755-0186

# Grips

## PARALLEL JAW GRIPS

Individually controlled serrated jaws to accept a wide variety of test specimens.

A	B	MAX SAMPLE SIZE	RATED UP TO	FIXING THREAD	PART NO.
57.1mm (2.25in)	6mm (0.24in)	30 X 6mm (1.18 x 0.24in)	1000N	10/32 UNF	49755-0194

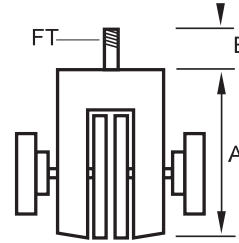

## SMALL PARALLEL GRIPS

Rigid body with individually controlled serrated jaws. Floating ball screw attachment ensures central loading during tensile testing.

MAX SAMPLE SIZE A	JAW DEPTH B	RATED UP TO	FIXING THREAD	PART NO.
10mm (0.39in)	20mm	1000N	10/32 UNF	49755-0202

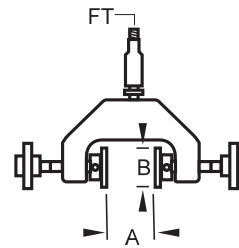

## FABRIC GRIPS

Designed for testing fabric to a number of different International Standards. Coated faces may be inserted to provide additional gripping strengths.

MAX SAMPLE SIZE A X B	RATED UP TO	FIXING THREAD	PART NO.
50 X 4mm (1.97 x 0.16in)	200N	10/32 UNF	49755-0210
100 X 4mm (3.94 x 0.16in)	100N	10/32 UNF	49755-0228

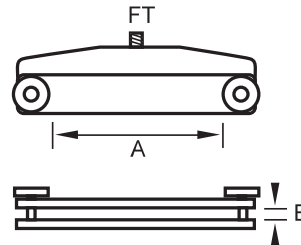

## PIN VICE

General purpose pin vice, serrated grip with 1.5mm V groove to grip wire or connector pins.

MAX A	JAW DEPTH B	C	RATED UP TO	FIXING THREAD	PART NO.
7mm (0.28in)	20mm (0.8in)	78mm (3.07in)	100N	10/32 UNF	49755-0236

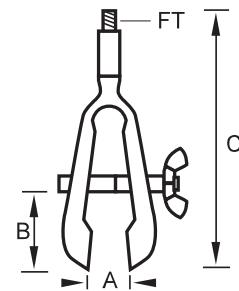

## PIN CHUCK

Designed for gripping circular or rod type specimens.

MAX SAMPLE ØA	B	RATED UP TO	FIXING THREAD	PART NO.
2.5mm (0.1in)	75mm (2.95in)	100N	10/32 UNF	49755-0244

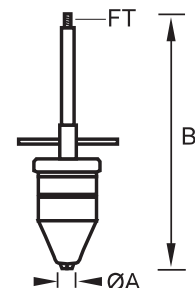

# Grips

## WIRE GRIPS



Designed for tension testing of wire, cord and filaments. Grooved mandrel and swivel plate designed to ensure center break and specimen alignment when force is applied.

A	RATED UP TO	FIXING THREAD	PART NO.
100mm (3.95in)	1000N	10/32 UNF	49755-0251

## MINIATURE FILAMENT FIXTURES

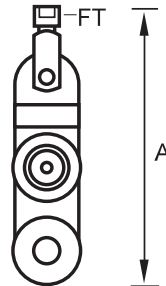

Designed for the tension testing of fine wire and yarn. Grooved mandrel and swivel plate designed to ensure center break and specimen alignment when force is applied.

A	RATED UP TO	FIXING THREAD	PART NO.
80mm (3.15in)	250N	10/32 UNF	49755-0269

## MULTI JAW GRIP FIXTURE

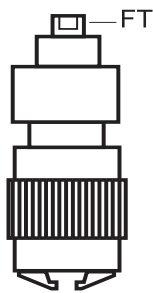

A unique fixture, designed for gripping round and irregular shaped objects. Often used in the toy testing and clothing industries.

SAMPLE SIZE DIAMETER	RATED UP TO	FIXING THREAD	PART NO.
10mm - 45mm (0.39 - 1.77in)	500N	M6	49755-0277

# Compression plates

**HARDENED & GROUND**

For spring testing and general compression tests.

ØA	FIXING THREAD	PART NO.
12mm (0.47in)	10/32 UNF	49755-0285
19mm (0.75in)	10/32 UNF	49755-0293
50mm (1.97in)	10/32 UNF	49755-0301
70mm (2.76in)	5/16 UNC	49755-0319
100mm (3.94in)	5/16 UNC top MWD/M5KNETOP	49755-0327
100mm (3.94in)	5/16 UNC bottom FITS ONTO MWD/M5KNE BASE PLATE	49755-0335



**NICKEL PLATED**

For general compression tests.

ØA	FIXING THREAD	PART NO.
12mm (0.47in)	10/32 UNF	49755-0343
19mm (0.75in)	10/32 UNF	49755-0350
19mm (0.75in)	5/16 UNC	49755-0368
50mm (1.97in)	10/32 UNF	49755-0376
50mm (1.97in)	5/16 UNC	49755-0384



**BLACK FINISH**

Fits into the MWD and M5KNE base plate.

ØA	FIXING THREAD	PART NO.
175mm (6.89in)	5/16 UNC	49755-0392

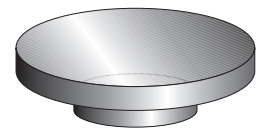
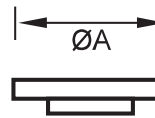

**VENTED**

Allows air-release during top-load testing. For use with tests to ASTM D2659.

ØA	FIXING THREAD	PART NO.
50mm (1.97in)	10/32 UNF	49755-0400

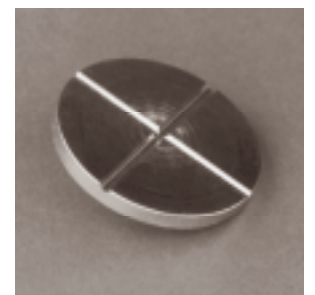
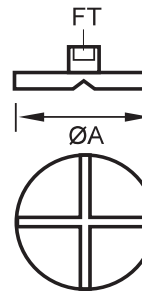

**SELF LEVELLING**

Self levelling compression plates allow parallelism to be set for accurate spring testing. Hardened and Ground. Supplied for either top or bottom use. 10/32 or 5/16 fixing thread available.

ØA	DIAGRAM	PART NO.
50mm (1.97in)	1 & 2	49755-0418
100mm (3.94in)	1	49755-0426
175mm (6.89in)	1	49755-0434

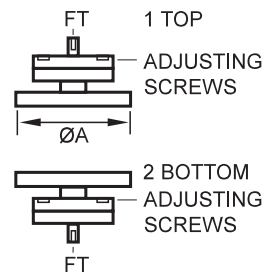

# Terminal testing

## ADJUSTABLE TEST HOOK - CRIMP JOINT TESTING

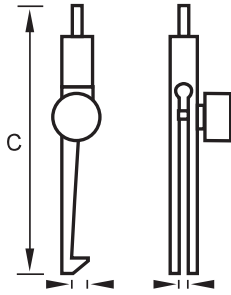

Used for holding smaller crimp terminals for tests to BSI spec. BS5G178 PART 1 and equivalent international standards.

A	MAX JAW B	C	RATED UP TO	FIXING THREAD	PART NO.
5mm (0.20in)	2mm (0.8in)	56.1mm (2.21in)	75N	10/32 UNF	49755-0087

## CABLE CAM GRIP

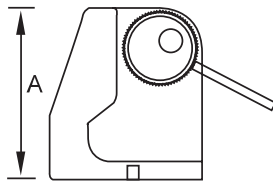
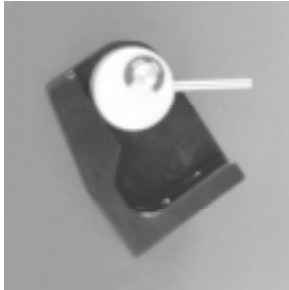

Optional smooth or serrated cams allow quick and positive clamping for cables up to 6mm diameter. For tests to BSI spec. BS5G178 PART 1 and equivalent international standards. Supplied with 10/32 screw for mounting on the base plate of the stand.

A	MAX CABLE DIAMETER	RATED UP TO	TYPE	PART NO.
75mm (2.95in)	6mm (0.24mm)	1000N	Serrated	49755-0475
75mm (2.95in)	6mm (0.24mm)	1000N	Smooth	49755-0483

## DOUBLE CAM GRIP

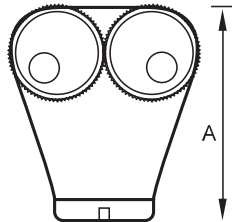
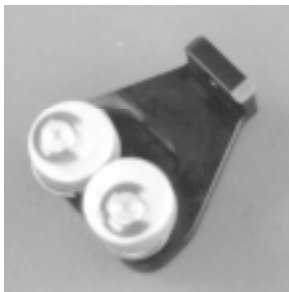

Special quick acting double cam grip for rapid repeat testing of substrates for tests to BSI spec. BS5G178 PART 1 and equivalent international standards. Supplied with 10/32 screw for mounting on the base plate of the stand.

A	MAX SAMPLE SIZE	MIN MAT RUN	RATED UP TO	PART NO.
62mm (2.45in)	2mm (0.08in)	10mm (0.40in)	500N	49755-0491
62mm (2.45in)	5mm (0.2in)	15mm (0.59in)	1000N	49755-0509

## ROTATIONAL CRIMP RECEPTACLE - CRIMP JOINT TESTING

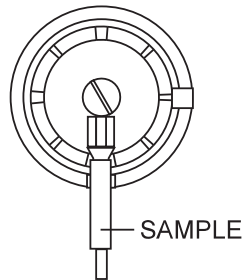

Crimp termination holder for tests to BSI spec. BS5G178 PART 1 and equivalent international standards. Adjustable for 10 sizes from 1.5mm (0.6") to 5mm (0.2").

SAMPLE SIZE DIAMETER	RATED UP TO	FIXING THREAD	PART NO.
0.6" - 0.12"	1000N	10/32 UNF & 15/16 UNC	49755-0517

## SPADE TERMINAL TESTING

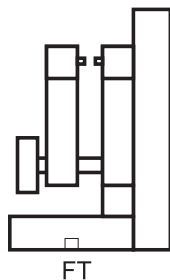

Accessory for insertion and withdrawal testing to BS 5057 and equivalent international standards. Available with master spades or spade terminal holder. Supplied with 10/32 screw for mounting on the base plate of the stand.

SIZE	FIXING THREAD	PART NO.
Spade sizes made to order	10/32	49755-0525

# Terminal testing

## FLAG TERMINAL ACCESSORY - TERMINAL TESTING

Adjustable to suit a wide range of flag terminals.

A	B	MAX SAMPLE Ø	RATED UP TO	FIXING THREAD	PART NO.
60mm (2.36in)	45mm (1.77in)	6mm (0.24in)	1000N	10/32 UNF	49755-0533

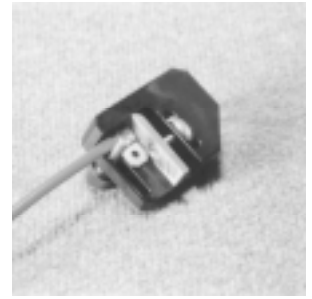
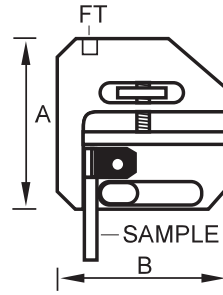

## WEDGE GRIPS

These self tightening tensile grips feature lever operated quick release serrated jaws, so providing excellent sample grip, on a variety of material.

MAX SAMPLE SIZE JAW DEPTH	RATED UP TO	FIXING THREAD	PART NO.
15 X 5mm (0.59 X 1.2in)	17mm (0.67in)	1000N	10/32 UNF 49755-0178
25 x 10mm (0.98 X 0.39in)	28mm (1.10in)	10000N	5/16 UNC 49755-0186

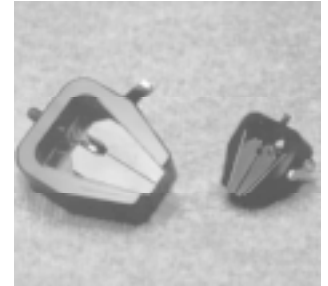
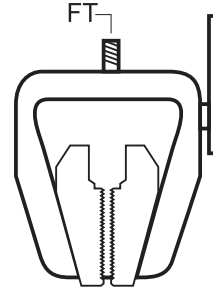

# Spring testing

## ADJUSTABLE SPRING RECEPTACLE

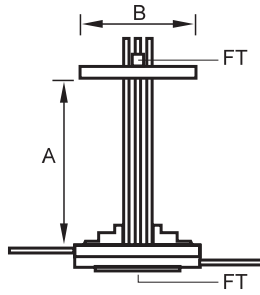

Used to accurately test flexible springs with a high length to diameter ratio. The three support columns locate on either the I/D (inner diameter) or O/D (outer diameter) of the spring. This prevents buckling thereby maintaining accuracy of results. Supplied complete with dedicated 50mm compression plate (nickel plated). This fixture must be used with the long extension 49755-0707 and cannot be used on LCP test stands due to reduced height.

I/D MAX	O/D MIN	A MAX	BØ	F.THREAD	PART NO.
45mm (1.77in)	8mm (0.31in)	131.7mm (5.19in)	50mm (1.97in)	10/32 UNF	49755-0541

## TORSION SPRING ACCESSORY

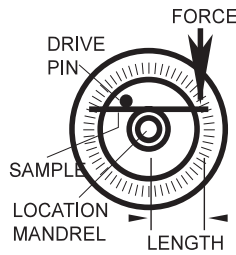
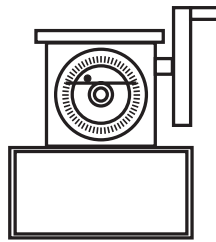

External dial indicates degrees of rotation. Supplied with drive pin and 5 mandrels for mounting of torsion springs. For use with force gauges, inverted chisel and MDD Manual Test Stand. Applies force at length - torque can then be calculated:  $Torque = Force \times Length$

MAX RATED TORQUE	Mandrel Ø	PART NO.
2N8m	5mm, 8mm, 10mm, 12mm, 15mm	49755-0558

# Peel testing

## PEEL WHEEL ACCESSORY

For peel testing flexible materials such as adhesive tapes.

$\varnothing A$	B	C	D	$\varnothing E$	PART NO.
80mm (3.15in)	20mm (0.79in)	18mm (0.71in)	34mm (1.34in)	78mm (3.07in)	49755-0616

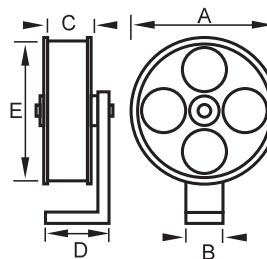

# Manual handling

## TROLLEY PUSHING ADAPTOR

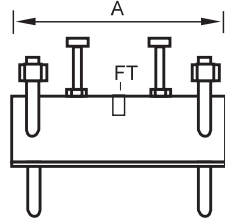

For use in manual handling tests on trolleys and pallet trucks with straight tubular steel handles without center boss.

A	RATED UP TO	FIXING THREAD	PART NO.
150mm (5.9in)	500N	10/32 UNF	49755-0731

## PADDED ADAPTOR SET

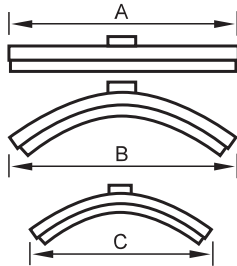

For use in ergonomic, physiotherapy, rehabilitation and physical fitness assessment. Rubber faced.

A	B	C	PART NO.
100mm (3.94in)	85mm (3.35in)	60mm (2.36in)	49755-0749

## MANUAL HANDLING CHAIN

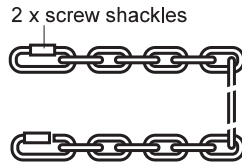

Designed to assist with manual handling accessories which involve pulling loads such as rollcontainers and trolleys. Recommended maximum load 1000N.

APPROX LENGTH	FIXING	PART NO.
800mm (315in)	2 x screw shackles	49755-0756

## FORCE GAUGE CRADLE

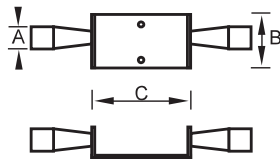

Allows force gauges to be used as a rigid hand held instrument enabling forces to be applied with both hands. Generally used for the higher capacity gauges.

Fixing Screws included 10/32 by 5/8  
(For single handed use, see pistol grip page 14)

A	B	C	PART NO.
28.9mm (1.74in)	80.3mm (3.16in)	106.0mm (4.17in)	49756-0011

# Adaptors & brackets

## DOVETAIL BRACKET

Standard bracket for mounting force gauge to test stand. Fixing screws included 10/32 by 5/8.

A	B	C	MAX CAP	PART NO.
89mm (3.15in)	25mm (0.98in)	9.5mm (0.37in)	2500N	49756-0037

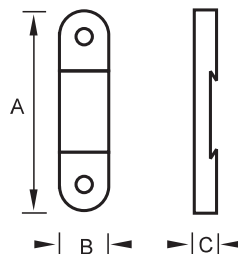

## EXTENDED DOVETAIL BRACKET

Provides 70mm (2.76in) of daylight for mounting force gauges to test stands (LCP). Fixing screws included 10/32 by 5/8.

A	B	C	MAX CAP	PART NO.
150mm (5.9in)	25mm (0.98in)	9.5mm (0.37in)	250N	49756-0045

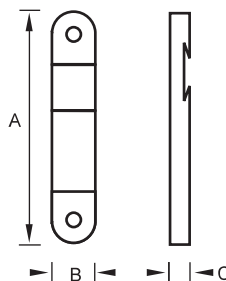

## MWD SWIVEL BRACKET FOR AFTI

For mounting of AFTI display to MWD column for easy viewing. Fixing screws included 10/32 by 5/8.

A	B	PART NO.
80mm (3.15in)	106mm (4.17in)	49762-0092

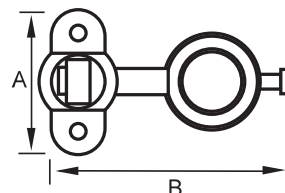

## ADAPTORS

For interchangeability of Dillon gauges, bench top test stands & accessories.

THREAD SIZE	GENDER	PART #
10-32 by 5/16 UNC	F-F	48575-0012
10-32 by M6	F-F	48575-0020
5/16 UNC by M6	F-F	48575-0038
10-32 by 10-32	F-F	48578-1918
5/16 UNC by 5/16 UNC	F-F	48575-0046
5/16 UNC by M12	M-M	48576-0011
5/16 UNC by M10	M-M	48576-0029
M6 by M6	M-M	48580-0015
10-32 by 10-32	M-M	14521-0597
5/16 UNC by 5/16 UNC	M-M	14521-1140
5/16 UNC by M12	M-F	48577-0010

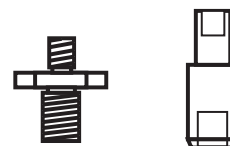

## TENSION BLOCK MODULE

For use with LCP test stand when applying tension.

A	B	C	FIXING THREAD	RATED UP TO	PART NO.
25mm (0.98in)	30mm (1.18in)	40mm (1.57in)	5/16 UNC 10/32 UNF	2500N	49756-0052

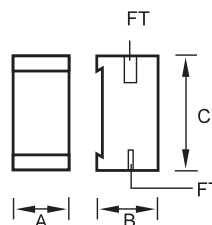

# General force accessories

## TOY TESTING - TEDDY BEAR FIXTURE

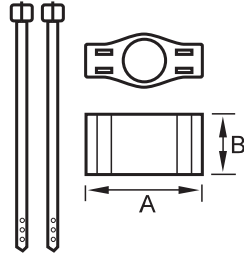
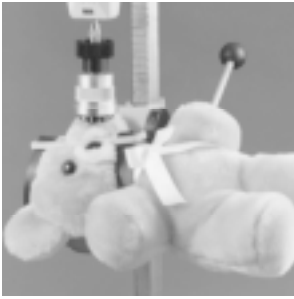

Designed to comply with BS 5665 PART 1: 1989, EN 71 PART 1: 1988. Base plate for use with MDD Stands. Shown with multi jaw gripping fixture, see page 14.

A	B	PART NO.
100mm (3.94in)	145mm (5.71in)	49755-0624

## SIMULATED CHILD JAWS (PAIR)

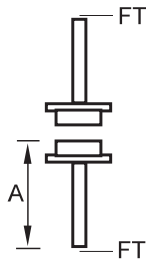

Designed to comply with BS 5239: 1988 to simulate a child's mouth for compressive biting tests.

A	B	FIXING THREAD	PART NO.
75mm (2.95in)	38mm (1.5in)	10/32 UNF	49755-0632

## RADIUSED FOOD PROBE

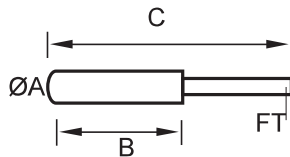

For texture or force profile testing of fruit, vegetables and baked products.

ØA	B	C	FIXING THREAD	PART NO.
8mm (0.31in)	30mm (1.18in)	60mm (2.36in)	10/32 UNF	49755-0640
11mm (0.43in)	30mm (1.18in)	60mm (2.36in)	5/16UNC	49755-0657

## INVERTED CHISEL

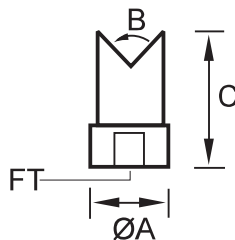
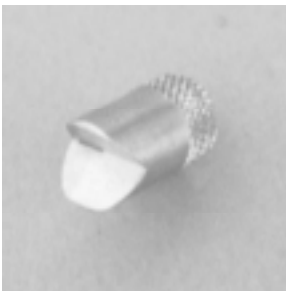

ØA	B	C	RATED UP TO	FIXING THREAD	PART NO.
8mm (0.32in)	90°	14 mm (0.55in)	1000N	10/32 UNF	49755-0665
12mm (0.47in)	90°	21mm (0.83in)	1000N	5/16 UNC	49755-0673

## CONE POINT

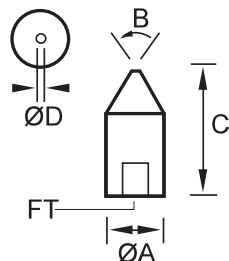
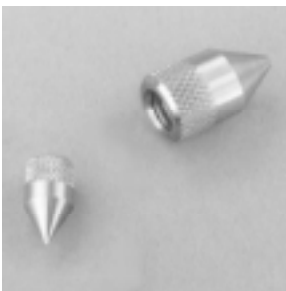

ØA	B	C	D	RATED UP TO	FIXING THREAD	PART NO.
8mm (0.35in)	60°	14mm (0.55in)	0.5mm (0.02in)	1000N	10/32 UNF	49755-0681
12mm (0.47in)	60°	21mm (0.83in)	2mm (0.08in)	1000N	5/16 UNC	49755-0699

# General force accessories

## CHISEL POINT

A	B	C	D	RATED UP TO	FIXING THREAD	PART NO.
8mm (0.02in)	14 mm (0.55in)	0.5mm (0.02in)	60°	1000N	10/32 UNF	49755-0707
12mm (0.08in)	21mm (0.83in)	2mm (0.08in)	60°	2500N	5/16 UNC	49755-0715

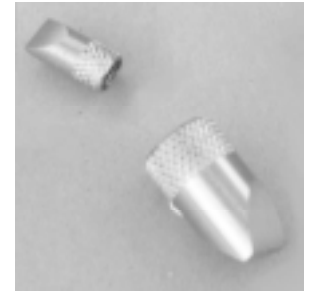
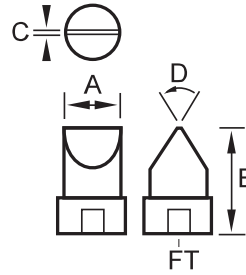

## EXTENSION RODS

ØA	B	RATED UP TO	FIXING THREAD	PART NO.
6mm (0.24in)	130mm (5.12in)	1000N	10/32 UNF	49755-0921
6mm (0.24in)	130mm (5.12in)	2500N	5/16 UNC	49755-0939
12mm (0.47in)	30mm (1.18in)	1000N	10/32 UNF	49755-0947
12mm (0.47in)	30mm (1.18in)	2500N	5/16 UNC	49755-0954

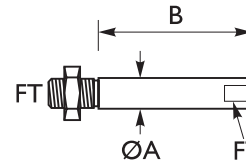

## OVERLOAD PROTECTION DEVICE

Designed to prevent compression only overload of force gauges and loadcells up to 250N.

Other options available:

- Compression and Tension Devices
- Higher or Lower Capacities

A	B	ØC	FIXING THREAD	PART NO.
20mm (0.79in)	80mm (3.15in)	75mm (2.95in)	10/32 UNF	49756-0060

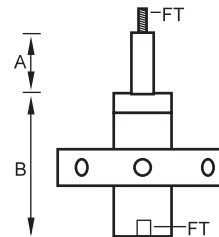

## ROD END BEARINGS

RATED UP TO	THREAD SIZE	MAX CAP. DYNAMIC	MAX CAP. STATIC	A	B	ORDER NO.
1 kN	M6	3.40kN	9.65kN	21mm (0.83in)	46.5mm (1.83in)	49755-0764
5 kN	M10	8.15kN	23.20kN	29mm (1.14in)	62.5mm (2.46in)	49755-0772
10 kN	M12	10.80kN	32.50kN	34mm (1.34in)	71mm (2.80in)	49755-0780
25 kN	M16	21.20kN	47.50kN	46mm (1.81in)	92mm (3.62in)	49755-0798
50 kN	M24	48.00kN	80.00kN	64mm (2.52in)	126mm (4.96in)	49755-0806
100 kN	M36	80.00kN	104.0kN	82mm (3.23in)	181mm (7.13in)	49755-0814

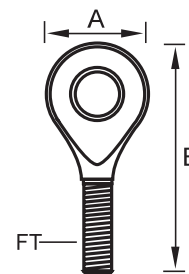

## LOAD BUTTONS

FIXING THREAD	PART NO.
M6	49755-0442
M10	49755-0459
M12	49755-0467
M16	49755-0970
M24	49755-0988
M36	49755-0996

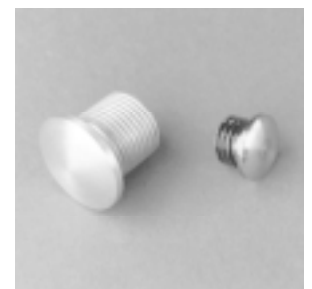
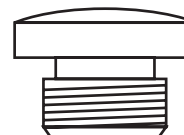

# General force accessories

## FORCE GAUGE CRADLE

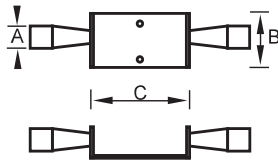

Allows force gauges to be used as a rigid hand held instrument enabling forces to be applied with both hands. Generally used for the higher capacity gauges.

Fixing Screws included 10/32 by 5/8"  
(For single handed use, see pistol grip page 14)

A	B	C	PART NO.
28.9mm (1.14in)	80.3mm (3.16in)	106.0mm (4.17in)	49756-0011

## PISTOL GRIP

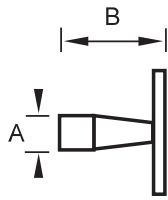

Allows force gauges to be used as a rigid hand held instrument. For single handed application of force. Generally used for the higher capacity gauges. Fixing screws included 10/32 by 5/8".

A	B	PART NO.
28.9mm (1.14in)	80.3mm (3.16in)	49756-0029

## MWD CROSSHEAD AFG MOUNT

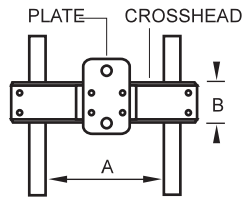

The crosshead needs to be ordered with the correct plate for the relevant force gauge

	A	B	PART NO.
AFG crosshead	225mm (8.86in)	50mm (1.98in)	49762-0039
MOUNTING PLATE FOR GAUGES UP TO			
Thick plate	1000N		49762-0047
Thin plate	2500N		49762-0054

## MDD FEET (PAIR)

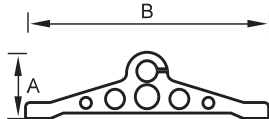

Optional feet for horizontal operation of the MDD test stand.

A	B	PART NO.
55.0mm (2.17in)	230mm (9.05in)	49758-0035

# Torque fixtures

## BOTTLE TOP / CAP TORQUE FIXTURE

Will accept cylindrical containers with diameters from 15mm (0.59in) up to 195mm (7.63in) and also a wide range of containers with other shapes, sizes and symmetries. Excluding torque sensor.

A	B	RATED UP TO	PART NO.
25.4mm (10.0in)	186mm (7.3in)	10N-m	49757-0010

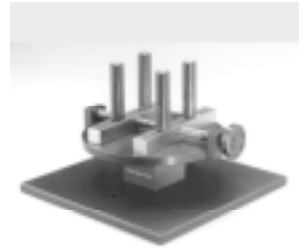
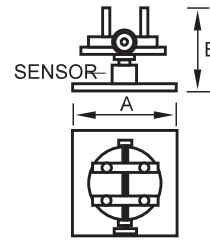

## MOUNT - STATIC TORQUE TRANSDUCER

Static torque transducer bench mounting stand for 15Nm to 600Nm smart torque loadcells

A	B	C	D	PART NO.
76mm (2.99in)	15mm (0.59in)	38mm (1.50in)	155mm (6.10in)	49757-0028

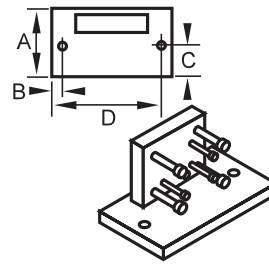

## MOUNT - TORQUE SENSE HEAD

Static torque transducer bench mounting stand for all torque screwdrivers.

A	B	C	D	PART NO.
76mm (2.99in)	15mm (0.59in)	38mm (1.50in)	155mm (6.10in)	49757-0036

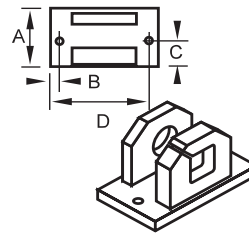

## RUNDOWN FIXTURE

Used for testing the stall torques of power tools and air drivers - decelerates the build-up of torques allowing more accurate peak readings to be taken.

RATED UP TO	A	ØB	PART NO.
10N-m	90mm (3.54in)	50mm (1.97in)	49757-0044
60N-m	90mm (3.54in)	50mm (1.97in)	49757-0051

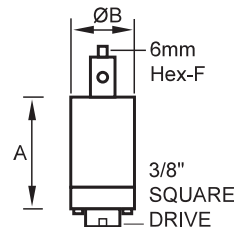

## 3-JAW CHUCK

For use with the Dillon Torque Screwdriver. Supplied with chuck key.

Ø MAX	B	PART NO.
3/8in (10mm)	3/8in Square Drive-Male	49757-0069
1/2in (12.7mm)	3/8in Square Drive-Male	49757-0077

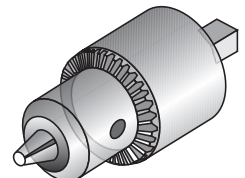
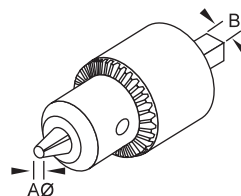

# Torque fixtures

## SQUARE DRIVE ADAPTOR

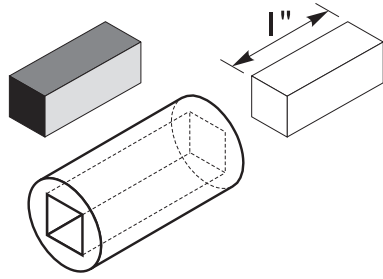

For use with the Dillon Torque Screwdriver.

	PART NO.
Square Drive 3/8in-Female to Square Drive 3/8in-Female	49755-0897

Other Adaptors: For use with Dillon static torque sensors.

Square Drive 1/2in-Female to Square Drive 1/2in-Female	49755-0905
Square Drive 3/8in-Male to Square Drive 3/8in-Male	49755-0913

# AFG/AFTI cables

CABLE	PART NO.
AFG/AFTI to PC (9 pin) serial cable for use with DataPlot	49756-1019
AFG/AFTI to PC (25 pin) serial cable for use with DataPlot	49756-1027
AFG/AFTI to Mitutoyo DPI-HS printer	49756-1035
AFG to TC <sup>2</sup> for reverse on alarm	49756-1043
Universal expansion module allows multiple cables to AFG/AFTI	49756-1050
Analog output cable for chart recorder	49756-1060

# Accessory kit



Supplied complete with a selection of gripping fixtures for general applications in force measurement testing.

	PART NO.
ACCESSORY KIT COMPLETE:	49755-5011
Double cam grip	see page 6
Rotational crimp receptacle	see page 6
Pin vice	see page 3
Lever operated cam grip	see page 2
Adjustable test hook	see page 6
Pin chuck	see page 3
Fabric grip	see page 3
Hardened & ground 50mm compression plate	see page 5
ACCESSORY KIT CASE - EMPTY	49755-5029

---

**This page left intentionally blank.**

---

R.D. Jacobs Company  
500 Southeast Thirteenth Street  
Fort Lauderdale, Florida 33316  
Phone: 954.462.1932  
Fax: 954.527.4466  
email: [info@dynamometers.com](mailto:info@dynamometers.com)



**DILLON**  
Force Measurement Products & Systems